

SM1000-2P & SM1000-2PF PARTS LISTING

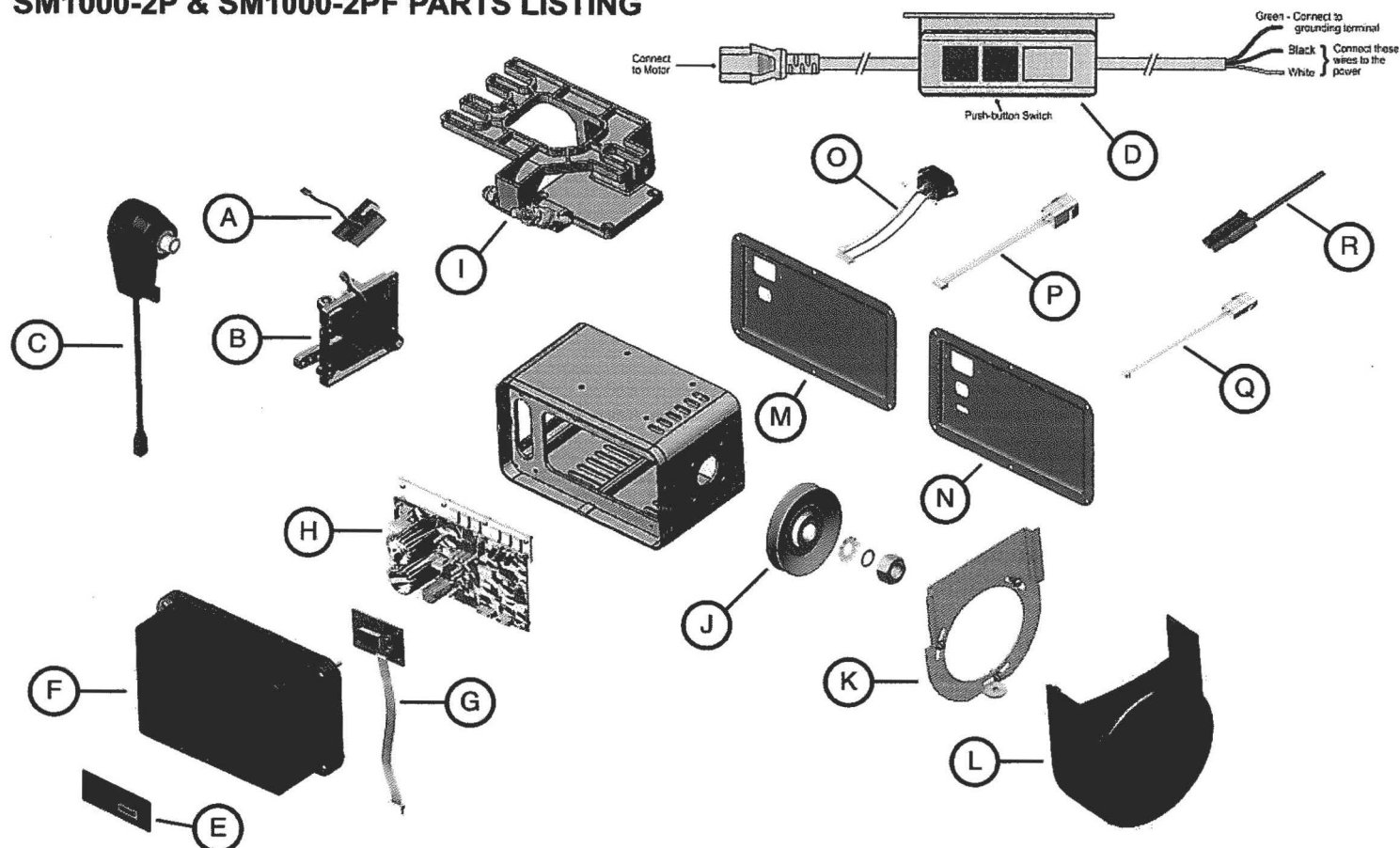

No. Fig. Description

SM76	A	Sensor only with screws (dual channel for motors with positioner)
SM104	B	Treadle sensor plate assembly complete with 4 screws (dual channel for motors with positioner) (877C)
SM77	C	Replacement positioner sensor kit complete
SM78	D	Complete horizontal wire harness for 220 volt models (431C)
SM106	E	SM1000-2P label
SM107	E	SM1000-2PF label
SM108	F	SM1000 Elite control box cover with 4 screws (431C Matte)
SM109	G	4 Digit LED display with screws
SM111	H	SM1000-2P circuit board with 6 Screws
SM112	H	SM1000-2PF circuit board with 6 Screws
SM113	I	Motor mounting bracket complete with 4 screws (877C)
SM50	J	50mm pulley with mounting hardware
SM60	J	60mm pulley with mounting hardware
SM75	J	75mm pulley with mounting hardware
SM80	J	80mm pulley with mounting hardware
SM90	J	90mm pulley with mounting hardware
SM100	J	100mm pulley with mounting hardware
SM79	K	Pulley cover bracket with screws and washers
SM86	L	Pulley cover with screw and washer (431C Matte)
SM116	M	Rear motor cover panel SM1000-2P with 6 screws (877C)
SM117	N	Rear motor cover panel SM1000-2PF with 6 screws (877C)
SM81	O	Power inlet receptacle with wires, terminals and screws complete
SM82	P	White positioner socket
SM83	Q	White foot lift socket
SM84	R	Male foot lift plug with wires